

h_{nom}	35 mm	
	18 Nm	
SIW 4AT-22 1/2"	✓	
SIW 6AT-A22 1/2"	✓	
SIW 6-22 1/2"	✗	
SID 2-A12 1/4"	✓	
SID 4-A22 1/4"	✓	
SID 6-22 1/4"	✓	

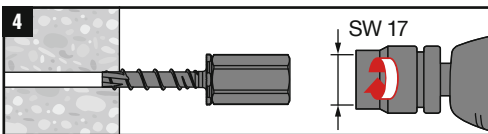

Min. 4.6 strength class, DIN 976-1
M8 / M10

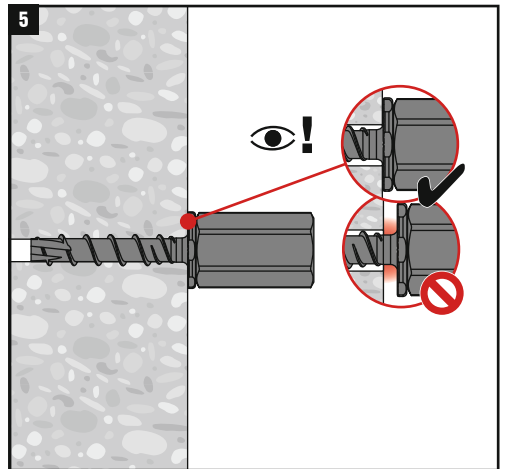
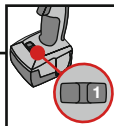
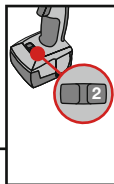
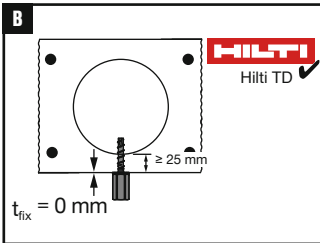
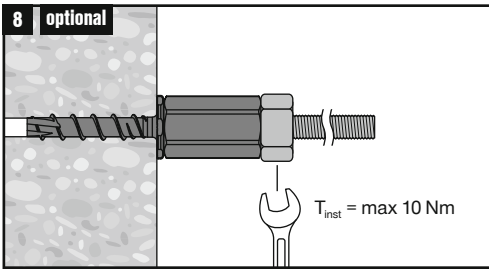
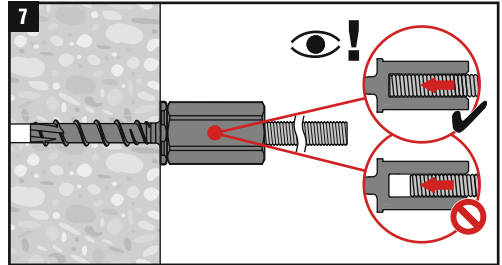
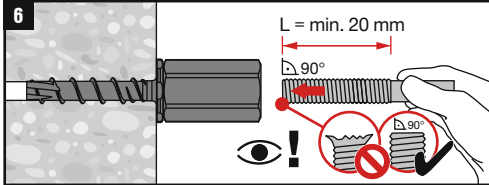

	SIW 6AT-A22 1/2"	✓		18 Nm
	SID 6-22 1/4"	✓		
	SIW 4AT-22 1/2"	✓		18 Nm
	SID 2-A12 1/4"	✓		
	SID 4-A22 1/4"	✓		
	SID 4-22 1/4"	✓		

