

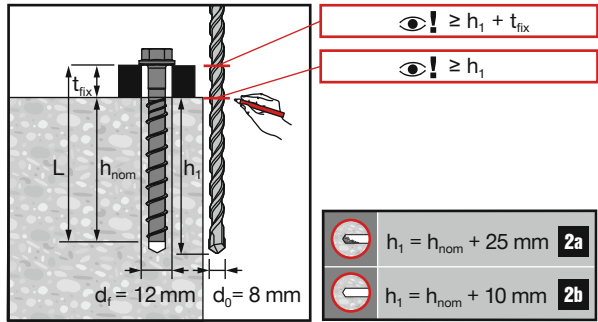

2310560-03.2025

<p>① CE</p> <p>25 Hilti AG LI-9494 Schaan Hilti Werke 2873-CPR-201-72 ETA-20/0867 Notified body 2873 EAD 330232-01-0601 Product for fixing to or connecting/supporting of building structures www.hilti.group</p>	<p>② CE</p> <p>22 Hilti AG, LI-9494 Schaan Hilti Werke 2873-CPR-201-78 ETA-21/0969 Notified body 2873 EAD 332947-00-0601 Product for fixing to or connecting/supporting of building structures www.hilti.group</p>	<p>③ CE</p> <p>25 Hilti AG, LI-9494 Schaan Hilti Werke 2873-CPR-201-83 ETA-23/0936 Notified body 2873 EAD 330460-00-0604 Product for fixing to or connecting/supporting of building structures www.hilti.group</p>
--	---	---

	①	②	③		①	②	③
HUS4-H 8×45	✓			HUS4-HF 8×65	✓	✓	
HUS4-H 8×55	✓			HUS4-HF 8×75	✓	✓	
HUS4-H 8×65	✓		✓	HUS4-HF 8×85	✓	✓	
HUS4-H 8×75	✓		✓	HUS4-HF 8×100	✓	✓	
HUS4-H 8×85	✓	✓	✓				
HUS4-H 8×100	✓	✓	✓				
HUS4-H 8×120	✓	✓	✓				
HUS4-H 8×150	✓	✓	✓				

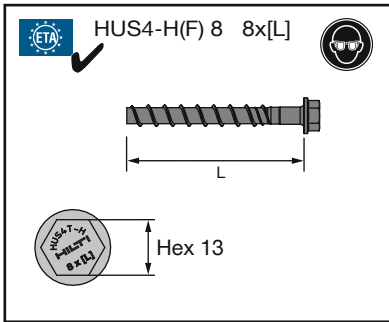

	$h_1 = h_{nom} + 25 \text{ mm}$	2a
	$h_1 = h_{nom} + 10 \text{ mm}$	2b

	h_{nom} [mm]
	≥ 40
	≥ 60
	≥ 60

SIW 6AT-A22 1/2", SIW 4AT-22 1/2"	✓	✓	
SIW 6-22 1/2", SIW 6AT-22 1/2"	✓		
SIW 22T-A 1/2", SIW 22T-A 3/4"	✓		
SIW 9-A22 3/4"			
SIW 8-22 1/2"			
SF 4-22, SF 6-22			✓

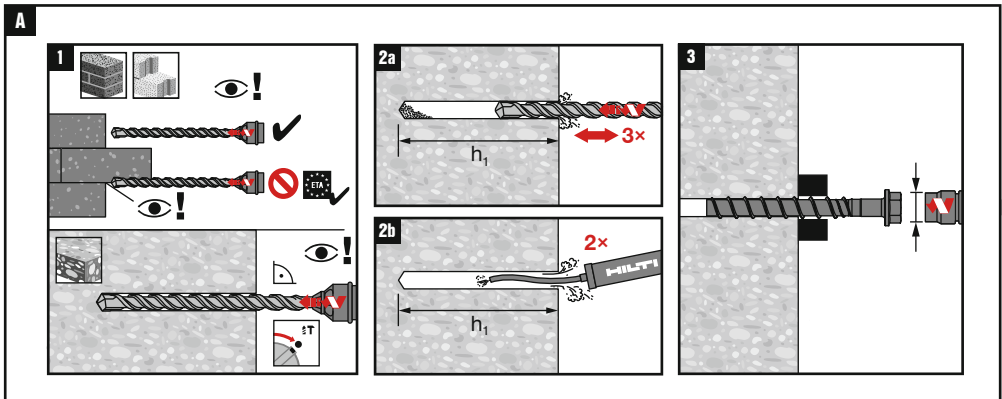

4 optional

4a

max. 10 mm
max. 2x

4b

h_{nom}
max. 10 mm

	h_{nom} [mm]	
	< 60	
	≥ 60	

5

B

DIBt - aBG

1

3a

4a

2

NURON

3b

4b

HUS4-H(F) 8

C

Hilti TD

1

e.g. PS 50, PS 300

2

≥ 50 mm

3

≥ 30 mm

4

5