

KH-EZ 1/2"	h ₁ *	h _{nom1} = 2.25" t _{fix1 max}	h _{nom2} = 3" t _{fix2 max}	h _{nom3} = 4.25" t _{fix3 max}	h _{nom4} = 5.5" t _{fix4 max}
1/2" x 2 1/2"	2 7/8" - t _{fix}	1/4"	-	-	-
1/2" x 3"	3 3/8" - t _{fix}	3/4"	-	-	-
1/2" x 3 1/2"	3 7/8" - t _{fix}	1 1/4"	1/2"	-	-
1/2" x 4"	4 3/8" - t _{fix}	1 3/4"	1"	-	-
1/2" x 4 1/2"	4 7/8" - t _{fix}	2 1/4"	1 1/2"	1/4"	-
1/2" x 5"	5 3/8" - t _{fix}	2 3/4"	2"	3/4"	-
1/2" x 6"	6 3/8" - t _{fix}	3 3/4"	3"	1 3/4"	1/2"
1/2" x 7"	7 3/8" - t _{fix}	4 3/4"	4"	2 3/4"	1 1/2"
1/2" x 8"	8 3/8" - t _{fix}	5 3/4"	5"	3 3/4"	2 1/2"

		h _{nom} ≤ 3"	h _{nom} > 3"	h _{nom} ≤ 3"	h _{nom} > 3"
	Nuron SID 4-22	✓	✓	✗	✗
	Nuron SID 6-22			✗	✗
	Nuron SIW 4-22				
	Nuron SIW 6-22	✗		✗	✗
	CPC SIW 22/18-A	✓	✗	✓	✗
	CPC SIW 22/18-TA	✗	✓	✗	✓
		45 ft-lb	45 ft-lb	25 ft-lb	25 ft-lb

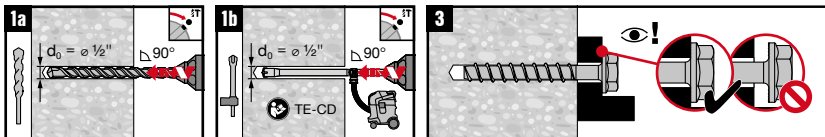

*For non-hole cleaning installation (step 1a), make sure to drill deep enough to achieve h₁, taking into account the depth of debris remaining in the hole.