

Frame anchor with hex head HRD-H



Base materials

- Concrete (aerated)
- Concrete (cracked)
- Concrete (hollow deck)
- Concrete (uncracked)
- Masonry (grout-filled CMU)
- Masonry (hollow)
- Masonry (hollow CMU)
- Masonry (solid)

Applications

- Fastening metal substructures for ventilated facades
- Typical applications for metal fabricators such as fastening handrails, window bars, railings, balustrades, etc.

Advantages

- Flexible embedment depth (approved at 50 mm and 70 mm embedment depth) - the ideal anchor for a huge range of applications in virtually all base materials
- Pre-assembled for optimum handling and fastening quality
- Available in several sizes, head configurations and materials for a wide range of applications

Technical data

| | |
|--|---|
| Material composition | Steel, zinc-plated (min. 5 µm), Polyamide |
| Head configuration | Hex head |
| Anchor size | 10 mm |
| Suitable for cracked concrete with redundant fastenings | Yes |

Approvals

| | |
|-----|---|
| ETA | ETA-07/0219 for HRD (ETAG 020-01, Option -) |
|-----|---|

Approvals and test reports may apply to selected products only. Please refer to the documents for details.

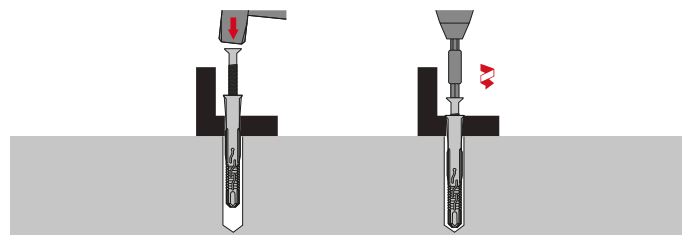

These are abbreviated instructions which may vary by application. Always review/follow the instructions accompanying the product or refer to www.hilti.com/techlib.

Anchor Systems

| Ordering designation | Drill bit diameter | Anchor length | Embedment depth 1 | Embedment depth 2 | Bit size | Fastening thickness at embed.2 | Sales pack quantity | Item number |
|----------------------|--------------------|---------------|-------------------|-------------------|----------|--------------------------------|---------------------|----------------------------|
| HRD-H 10x60 | 10 mm | 60 mm | 50 mm | | T40 | | 50 pc | 423870¹⁾ |
| HRD-H 10x100 | 10 mm | 100 mm | 50 mm | 70 mm | T40 | 30 mm | 50 pc | 423872¹⁾ |

¹⁾ This is a non-stock item. For detailed lead time information please contact your Hilti representative.

Please visit our website for the latest item numbers and related products.